

To: Operations & Scheduling Committee

Date: May 28, 2026

From: Pranjal Dixit, Manager of Planning

Reviewed by: *Ref*

SUBJECT: BusAID – Monument Corridor Transit Speed Improvements

Background:

The Bus Accelerated Infrastructure Delivery (BusAID) Complete Streets – Monument Corridor Transit Speed Improvements Project will adjust bus stops on Monument Boulevard between Mohr Lane and Detroit Avenue. County Connection was awarded \$385,885 in OBAG 3 (STP/CMAQ) federal funds for the design and construction of the project, with County Connection providing a local match of \$49,880 pursuant to a Master Funding Agreement approved by the Board in July 2024. The project focuses on the following:

- Optimizing bus stops: Consolidating stops and improving spacing for better efficiency (Phase 1).
- Improving accessibility: Upgrading bus stops to meet the Americans with Disabilities Act (ADA) standards (Phase 1).
- Enhancing signal timing: Implementing Transit Signal Priority (TSP) along Monument Boulevard between Detroit Avenue and Mohr Lane (Phase 2).

Through a data driven evaluation considering ridership, service levels, passenger loads, and equity, staff identified 14 bus stops along Monument Boulevard for transit priority improvements to be included in the project (see map, Attachment 1). Design work began in Fall 2025 and is now complete. The final blueprints incorporate vital city and community feedback gathered through the Concord Bicycle and Pedestrian Advisory Committee (BPAC) (see 100% plans, Attachment 2).

Next Steps

Following the finalization of construction bid documents, staff will launch the competitive bidding process. A contract award recommendation is expected to go before the Board in Fall 2026, with physical construction scheduled to begin shortly afterward.

Work is already underway for Phase 2, which deploys Transit Signal Priority (TSP) across eight signalized intersections on Monument Boulevard between Detroit Avenue and Mohr Lane. Through a parallel project funded by the Innovative Deployments to Enhance Arterials (IDEA) Grant, staff is currently finalizing the necessary signal timing plans. Staff will partner closely with the City of Concord to select a TSP vendor, ensuring all new hardware and software are fully compatible with existing traffic infrastructure. The project is scheduled for completion by Fall 2027.

Financial Implications:

The project is grant funded, with County Connection’s local match included in the existing budget.

Recommendation:

None, for information only.

Action Requested:

None, for information only.

Attachments:

Attachment 1: Project map showing affected bus stops

Attachment 2: 100% plans

MONUMENT BLVD STOP TREATMENTS

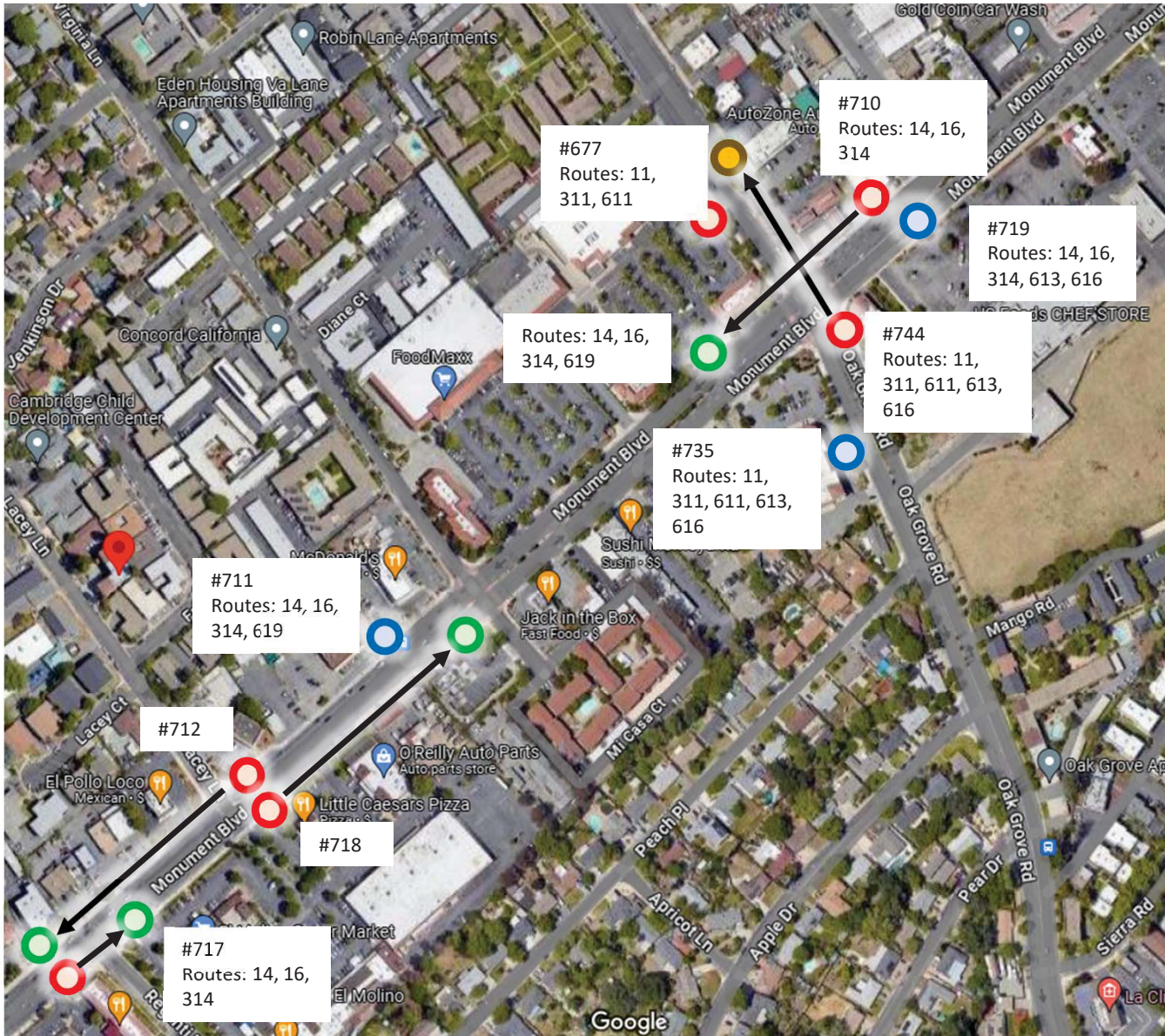

- Keep
- Eliminate
- Add
- Add + ADA Improvement

MONUMENT BLVD STOP TREATMENTS



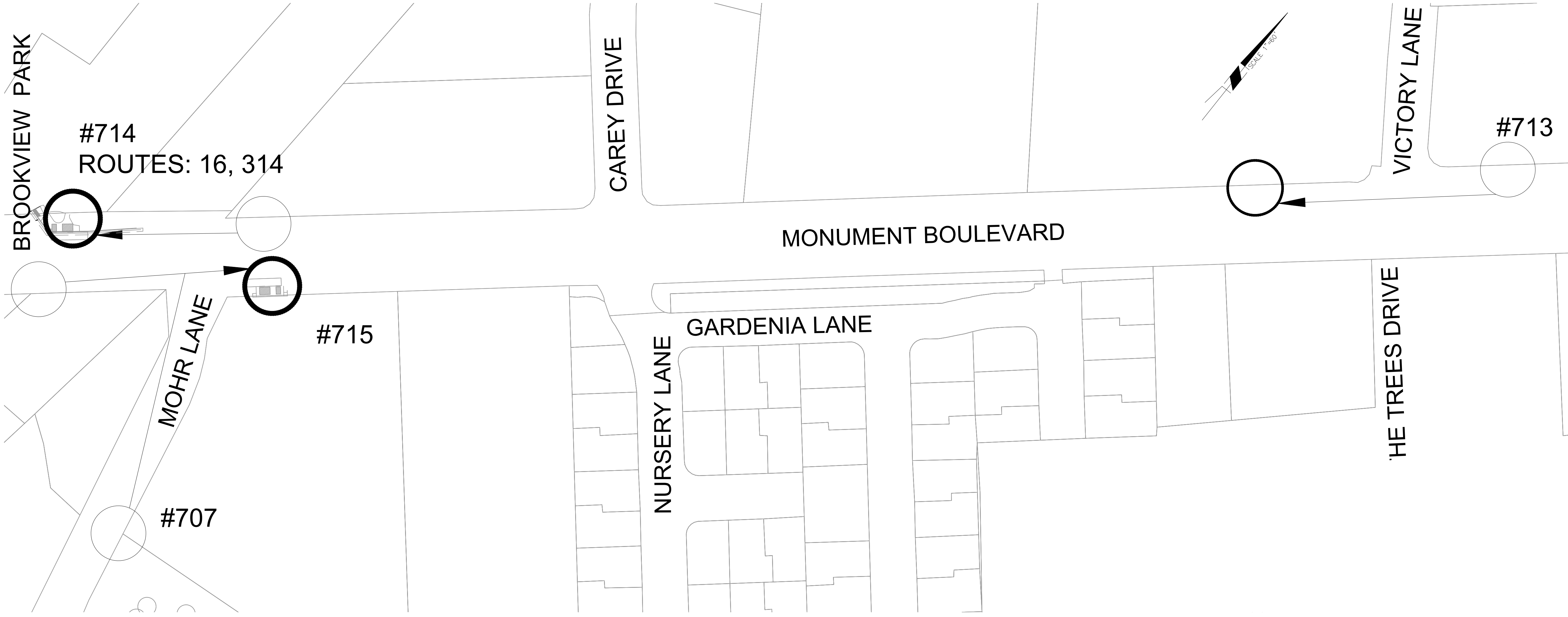

- Keep
- Eliminate
- Add
- Add + ADA Improvement



DATE: 03/13/2026	SCALE: 1" = 60'	PROJECT NO.: 2026-01
DESIGN: MC	DRAWN: MC	CHECKED: JH

**COUNTY CONNECTION
MONUMENT BOULEVARD
BUS STOP TREATMENTS
KEY MAP**

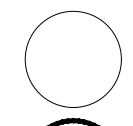
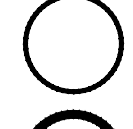
REV	DESCRIPTION	DATE

- NOTE:**
-  1. EXISTING STOP TO ELIMINATE (WORK DONE BY CCCTA STAFF)
 -  2. NEW STOP TO ADD (WORK DONE BY CCCTA STAFF)
 -  3. NEW STOP WITH ADA IMPROVEMENTS TO ADD (CONTRACT WORK)



CONTRACT NO.
2024-MA-02

PJ#
2026-01

SHEET NUMBER
KM-01

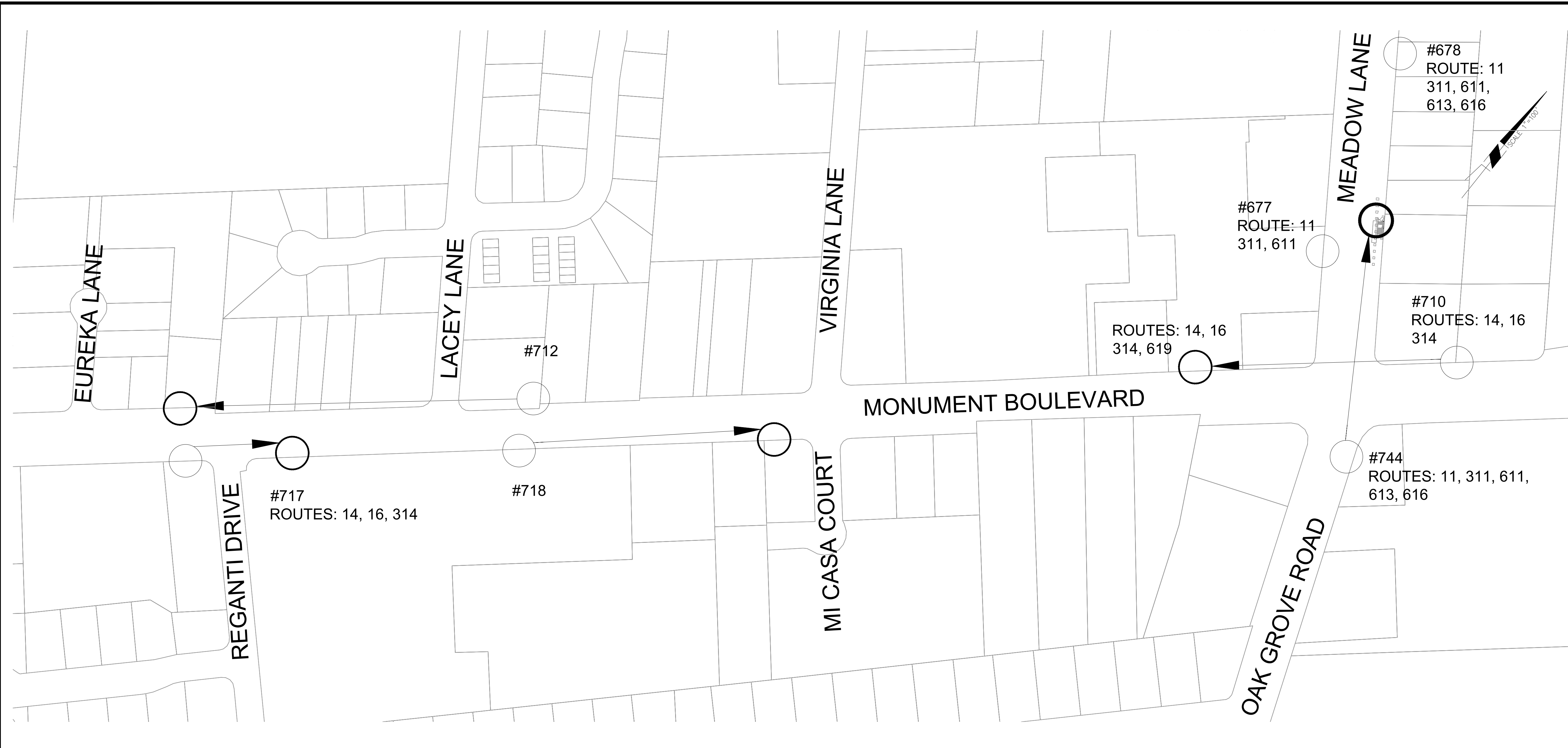

2 OF **6**



DATE: 03/13/2026	SCALE: 1" = 100'	PROJECT NO.: 2026-01
DESIGN: MC	DRAWN: MC	CHECKED: JH

**COUNTY CONNECTION
 MONUMENT BOULEVARD
 BUS STOP TREATMENTS
 KEY MAP**

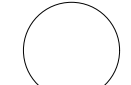
REV	DESCRIPTION	DATE

- NOTE:**
-  1. EXISTING STOP TO ELIMINATE (WORK DONE BY CCCTA STAFF)
 -  2. NEW STOP TO ADD (WORK DONE BY CCCTA STAFF)
 -  3. NEW STOP WITH ADA IMPROVEMENTS TO ADD (CONTRACT WORK)



CONTRACT NO.
2024-MA-02

PJ#
2026-01

SHEET NUMBER
KM-02

C:\Users\jharbin\OneDrive\Documents\2024-MA-02\2024-MA-02-KM-02.dwg

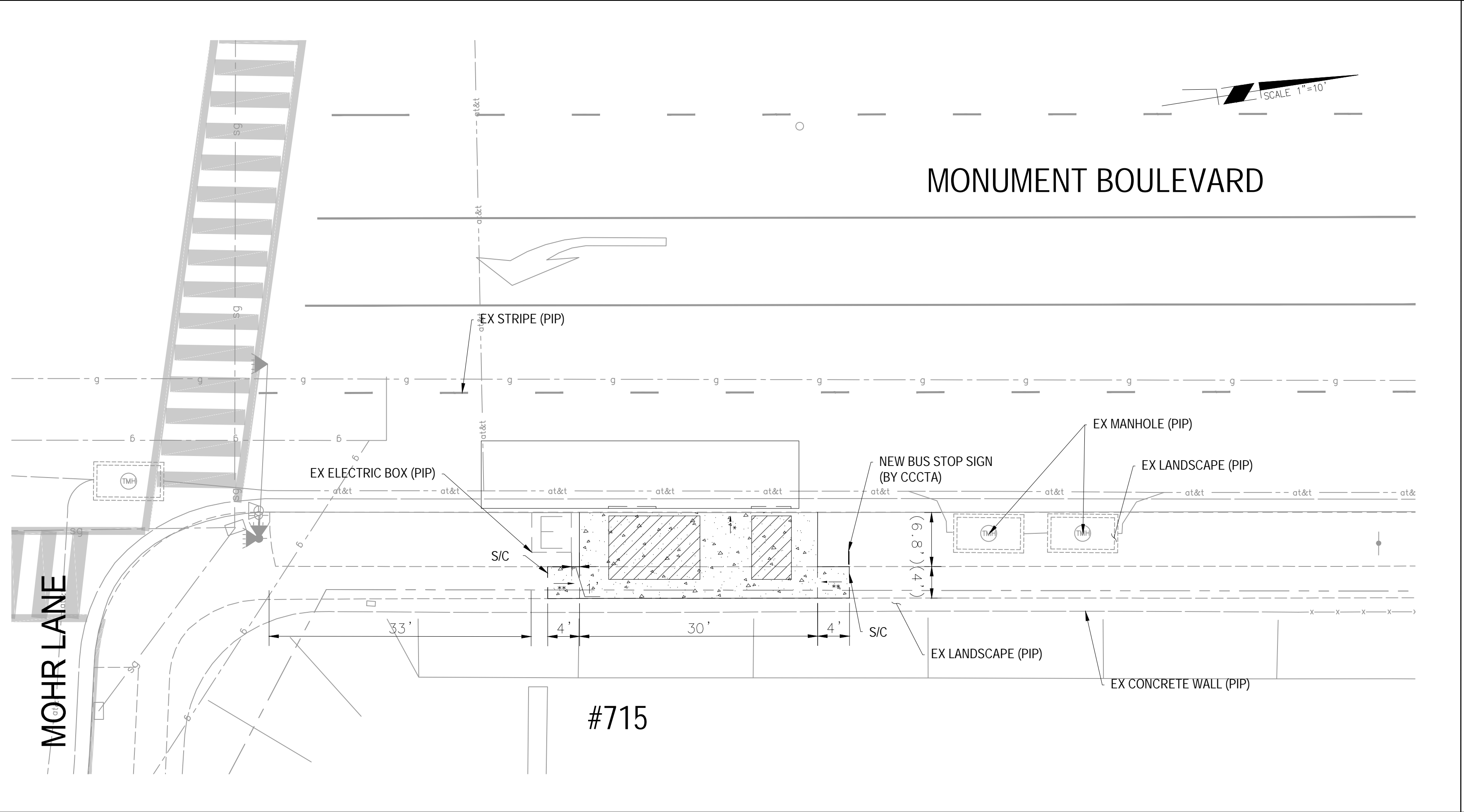
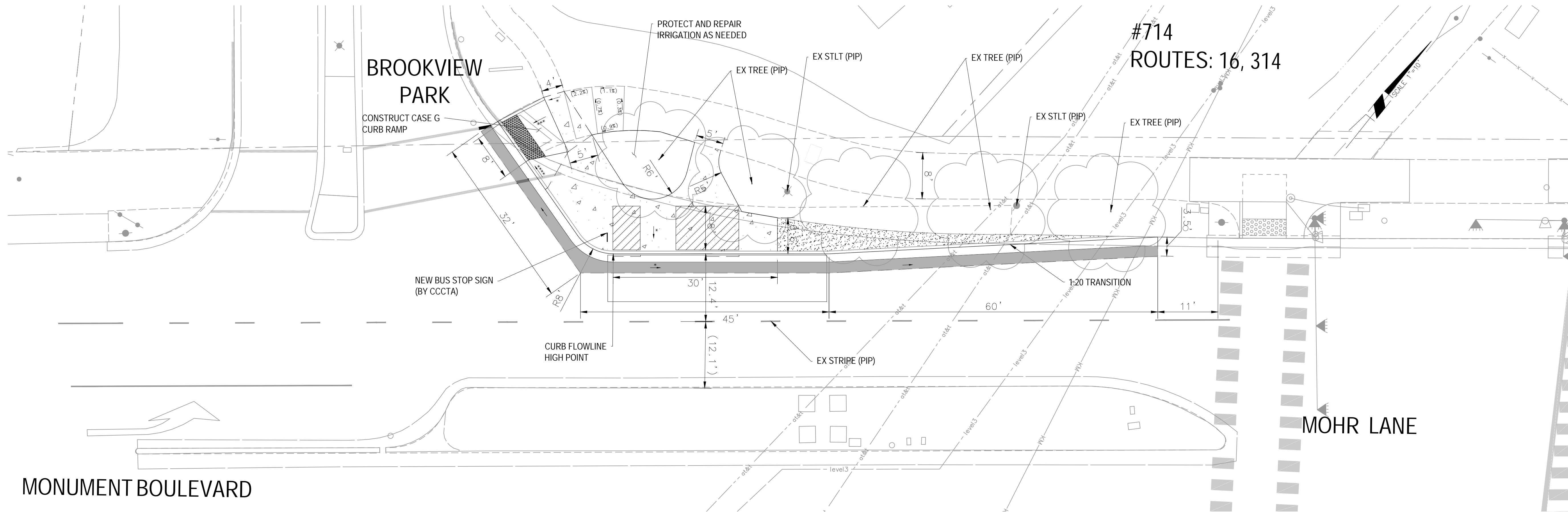

NOTE:

1. CONTRACTOR TO PROVIDE NOTIFICATION TO BROOKVIEW PARK NEIGHBORHOOD OF CONSTRUCTION ADJACENT TO THE PROPERTY.
2. AREA BEHIND NEW CURB AND GUTTER NOT IN THE LOADING ZONE TO BE DECOMPOSED GRANITE.

LEGEND:

- [Pattern] HMA TYPE A (12" THICK)
- [Pattern] PCC SIDEWALK
- [Pattern] DECOMPOSED GRANITE
- [Pattern] - MAX 1.5%
- [Pattern] - MAX 5.0%
- [Pattern] - MAX 7.5%
- [Pattern] - MAX 9.0%
- [Pattern] BUS LOADING ZONE FOR 40' BUS
MAX 1.5% SLOPE IN ALL DIRECTIONS

DATE: 03/13/2026	SCALE: 1" = 10'	PROJECT NO.: 2026-01
DESIGN: MC	DRAWN: MC	CHECKED: JH

**COUNTY CONNECTION
MONUMENT BOULEVARD
BUS STOP TREATMENTS
MONUMENT BLVD & MOHR LN**

REV	DESCRIPTION	DATE

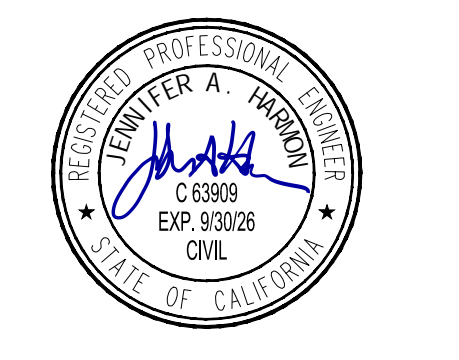

CONTRACT NO. 2024-MA-02
PJ# 2026-01
SHEET NUMBER DT-01
4 OF 6

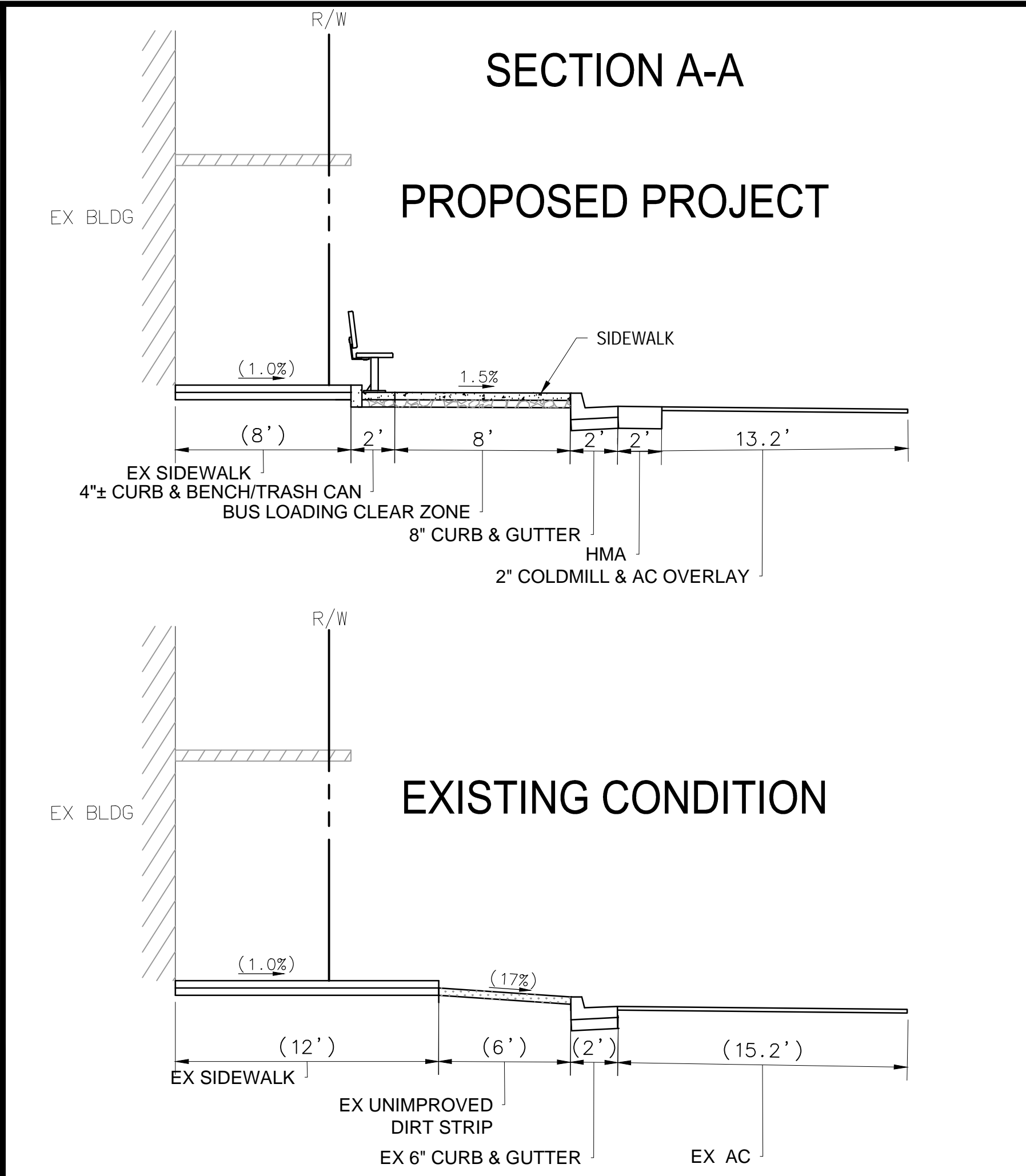
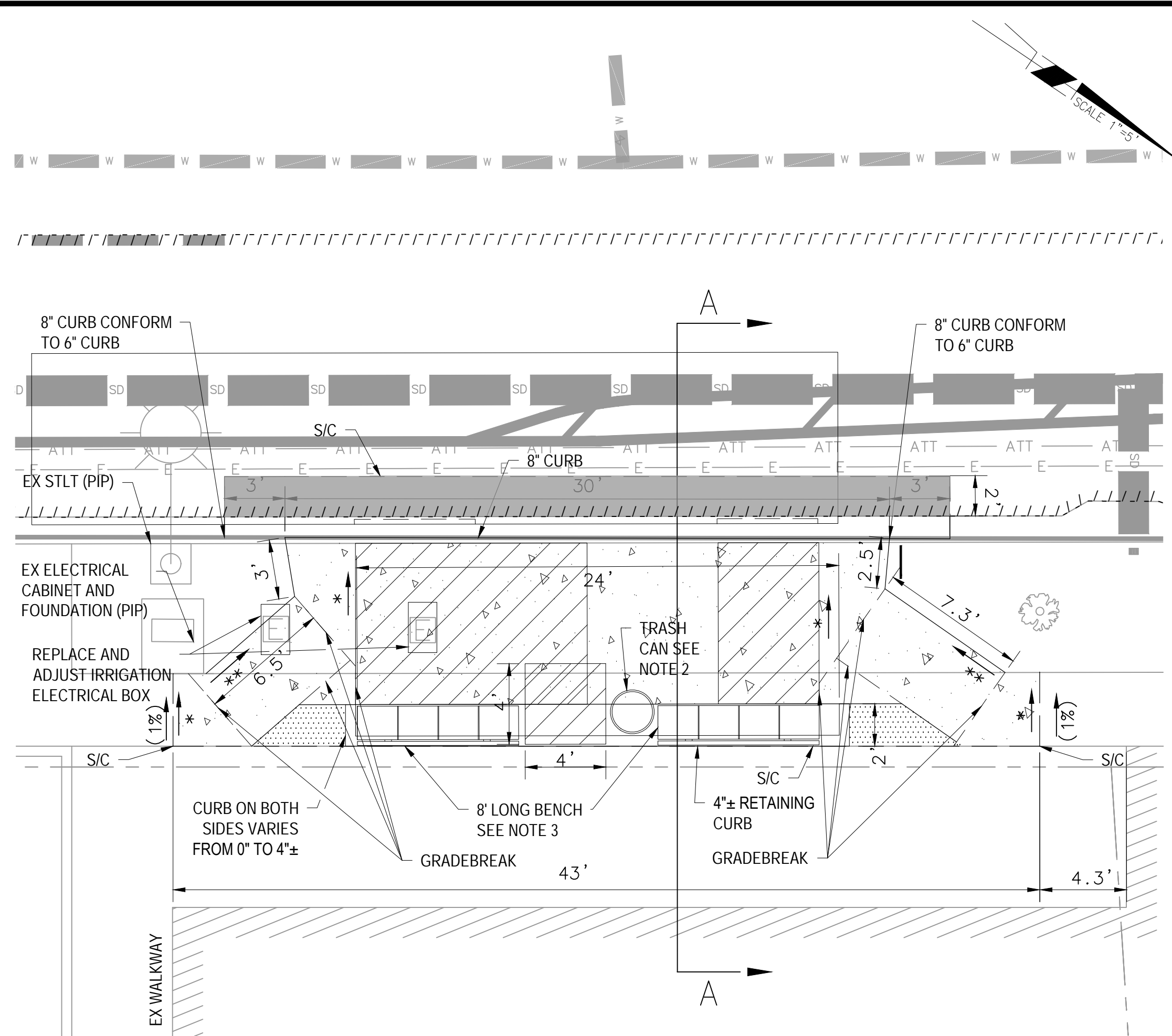

- NOTE:**
- CONTRACTOR TO PROVIDE NOTIFICATION TO BUSINESSES OF CONSTRUCTION ADJACENT TO THE PROPERTY.
 - TRASH CAN RECEPTACLE WITH HARD RUBBER LINER AND LOCKABLE LID WITH RAIN DIVERTER TOLAR SFTR-10 OR APPROVED EQUAL.
 - 8' LONG BENCH WITH BACK AND SEAT DELINEATORS, TOLAR SFBN-28 OR APPROVED EQUAL.

LEGEND:

- HMA TYPE A (12" THICK)
- PCC SIDEWALK
- PCC SIDEWALK COLORED DARK GREY
- 2" AC COLDMILL & OVERLAY
- MAX 1.5%
- MAX 5.0%
- BUS LOADING ZONE FOR 40' BUS
MAX 1.5% SLOPE IN ALL DIRECTIONS
- ADA RESTING AREA

DATE: 03/13/2026	SCALE: 1" = 5' & 1" = 20'	PROJECT NO.: 2026-01
DESIGN: MC	DRAWN: MC	CHECKED: JH

**COUNTY CONNECTION
MONUMENT BOULEVARD
BUS STOP TREATMENTS
MONUMENT BLVD & MEADOW LN**

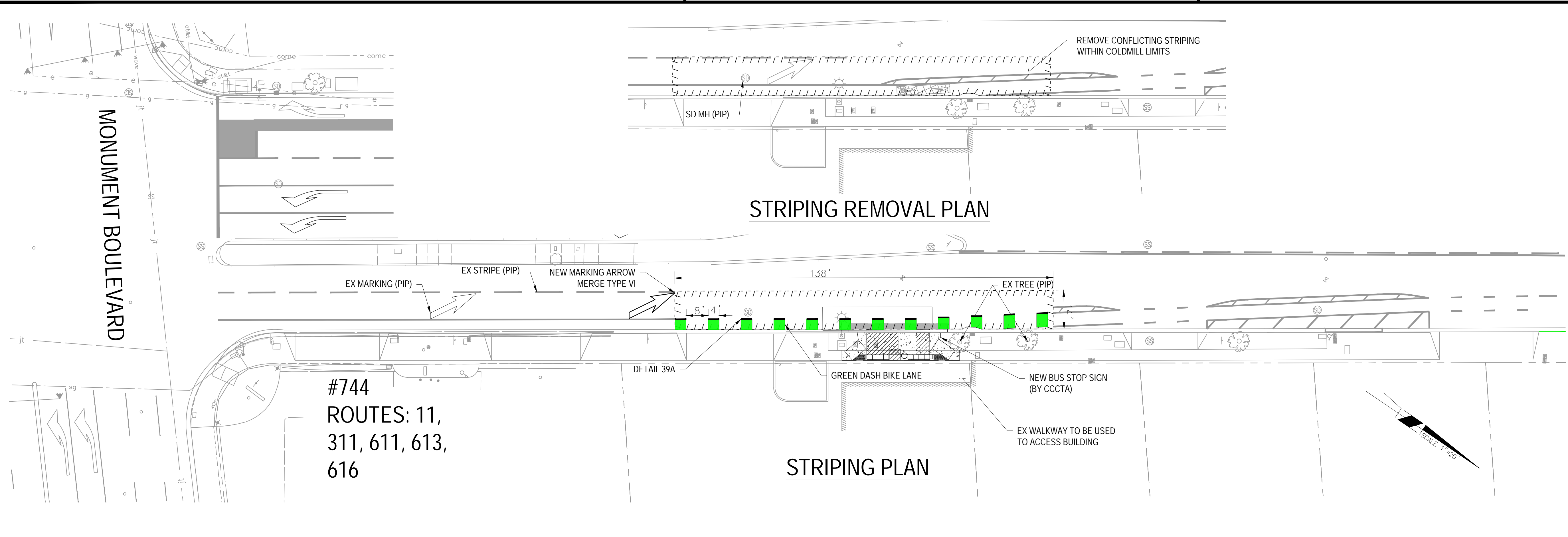

REV	DESCRIPTION	DATE



CONTRACT NO. 2024-MA-02
PJ# 2026-01
SHEET NUMBER DT-02
5 OF 6

DATE: 03/13/2026	SCALE: NA	PROJECT NO.: 2026-01
DESIGN: MC	DRAWN: MC	CHECKED: JH

COUNTY CONNECTION
 MONUMENT BOULEVARD
 BUS STOP TREATMENTS
 QUANTITY TABLE

SUMMARY OF QUANTITIES															
BUS STOP NO.	STREET	CROSS STREET	DETAIL SHEET	REMOVE SIDEWALK (SF)	RECONSTRUCT CURB (LF)	RECONSTRUCT CURB 8" (LF)	RETAINING CURB 0" TO 4" +/- (LF)	SIDEWALK (SF)	ADJUST UTILITY COVER TO GRADE (EA)	DECOMPOSED GRANITE (SF)	THERMOPLASTIC MARKING (SF)	GREEN THERMOPLASTIC MARKING (SF)	BENCH	TRASH CAN	COMMENTS
714	MONUMENT BOULEVARD	BROOKVIEW PARK	DT-01	105	133	-	0	658	-	153	4	-	-	-	CONSTRUCT CASE G CURB RAMP, 1:20 TRANSITION, DECOMPOSED GRANITE
715	MONUMENT BOULEVARD	MOHR LANE	DT-01	151	-	-	0	356	-	-	-	-	-	-	START BUS STOP LOADING ZONE CONCRETE 1 FOOT FROM CONCRETE BOX, 5% MAX RAMP SLOPE
744	MEADOW LANE	MONUMENT BOULEVARD	DT-02	156	-	36	28	367	2	-	42	195	2	1	ADJUST UTILITY COVERS TO GRADE, INSTALL 2 BENCHES & TRASH CAN BEHIND LOADING ZONE AND INFRONT OF SIDEWALK, REMOVE CONFLICTING STRIPING
BASE BID TOTAL				412	133	36	28	1381	2	153	46	195	2	1	

REV	DESCRIPTION	DATE



CONTRACT NO.
2024-MA-02

PJ#
2026-01

SHEET NUMBER

QT

6 OF 6